

QA1
GO DRIVE IT.



**QA1 64-70 FORD MUSTANG FRONT SWAY BAR
INSTALLATION INSTRUCTIONS: 52802, 52803**

WELCOME TO QA1!

OUR COMMITMENT

Congratulations on your purchase of this high-quality QA1 64-70 Ford Mustang Front Sway Bar assembly. It is engineered to the highest standards, utilizes the finest materials, and is built with exceptional craftsmanship and attention to detail.

While we understand your eagerness to start your build, please remember that your safety is our utmost priority. Always use an approved and appropriately rated jack, jack stand, or automotive lift, and take all necessary safety precautions to ensure the job is completed safely and correctly.

Before you start, read and understand all instructions thoroughly. With hand tools and essential equipment, you can do the main assembly and setup of your new front sway bar in your home garage, but if you feel unsure of your abilities during the assembly or installation and need some help or have any uncertainties, please seek the assistance of a qualified mechanic or automotive repair shop.

If you have any product questions or need guidance, please don't hesitate to call and speak with QA1 technical support at 952-985-5675.

Remember, we're here to support you every step of the way and are committed to ensuring your assembly and installation process is successful and enjoyable. We wish you all the best!

BEFORE INSTALLATION

Before you begin the QA1 64-70 Ford Mustang Front Sway Bar installation, read and understand these instructions carefully. If instructions are not correctly followed, personal injury, equipment, or product damage can result.

Products that have been installed are not eligible for returns. To prevent mistakes, thoroughly read these instructions before you start the Rear Sway Bar assembly procedure.

Check your order as soon as possible upon delivery. QA1 has provided parts list tables and images, as shown on pages 4 through 7. Compare your order's contents against the tables. Call your authorized dealer immediately if you discover anything missing from your order.

This kit uses fasteners to assemble and install. Welding is not required.

It is important to wear the appropriate personal protective equipment (PPE). However, the responsibility does not end there. Follow the manufacturer's instructions for safe use when working with power tools, and be cautious and responsible in your work.

ABOUT THIS MANUAL

PURPOSE

These instructions outline the QA1 64-70 Ford Mustang Front Sway Bar kit. This system is designed to work with only the QA1 lower control arm.

ITS CONTENTS

The information that follows is described in this instruction set:

- Required tools and supplies.
- Safety, hazard, and warning rules.
- Product overview and included parts.
- Installation and the setup procedures required for use.

Pages with images will have paragraphs and sentences with callout numbers that refer to their respective images, steps, and parts.

Procedures, once described in the text, are generally not repeated. When it is necessary to refer to another procedure, the page and step reference will be given.

REQUIRED TOOLS AND SUPPLIES

- Floor Jack
- Jack Stands
- SAE Wrench Set
- SAE Socket Set
- Torque Wrench (lb-ft)
- Anti-Seize Lubricant

SAFETY FIRST

- Work on your vehicle in an appropriate location.
- Park your car on a level surface.
- Use wheel chocks to prevent vehicle roll.
- Check your owner's manual for the correct jack lift points.
- Always support your vehicle with jack stands.
- Wear personal protection like safety glasses, gloves, and a fine particle respirator mask.
- Never use compressed air to clean brake or metal grinding dust from the brake, suspension components, frame, or rear axle housing.
- Grind metal only in a well-ventilated area, and wear a respirator until the dust has settled and the work area air has been cleared.
- Dispose of damaged or old parts in accordance with local laws. Do not throw any hazardous waste in the trash.
- Follow the manufacturer's instructions for safe use when working with power tools, and be cautious and responsible in your work.



CONTENTS

QA1 FRONT SWAY BAR..... 4-12

PARTS LIST 4

INSTALLATION 8-12

WARRANTY..... 13



52802 64-66 FORD MUSTANG
REAR SWAY BAR KIT

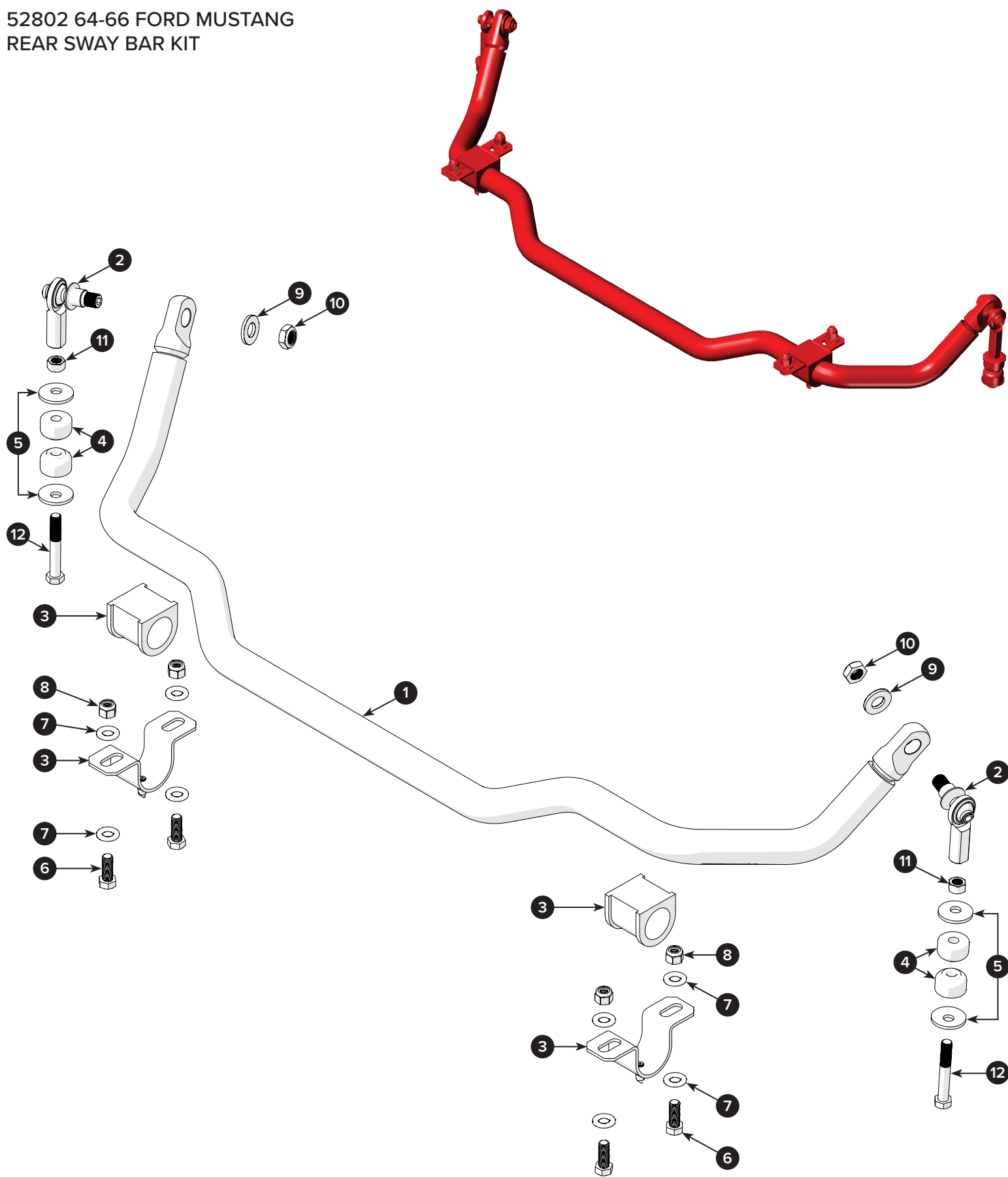

52802 64-70 FORD MUSTANG FRONT SWAY BAR w/INSTALL KIT 7039-482

POSITION	PART #	DESCRIPTION	QTY	TORQUE SPECIFICATION
1	7039-478	SWAY BAR	1	—

64-70 FORD MUSTANG FRONT SWAY BAR INSTALL KIT 7039-482 w/HARDWARE KIT 7039-483

POSITION	PART #	DESCRIPTION	QTY	TORQUE SPECIFICATION
2	PCYFR6TS-101	ROD END (PCY) 2-PC HI-MIS-STUD	2	—
3	9032-171	BUSHING KIT, SWAY BAR FRAME MOUNT 1-1/4"	1	—
4	9032-349	BUSHING, SWAY BAR END LINK	4	—
5	9005-270	WASHER, SWAY BAR BUSHING	4	—

64-70 FORD MUSTANG FRONT SWAY BAR HARDWARE KIT 7039-483

POSITION	PART #	DESCRIPTION	QTY	TORQUE SPECIFICATION
6	9012-229	BOLT, HEX, 3/8-16 X 1.0"	4	30 LB-FT
7	9005-302	WASHER, FLAT 3/8" SAE HARDENED	8	—
8	NA	NUT, NYLOCK 3/8-16	4	—
9	9005-228	WASHER, FLAT 1/2" SAE	2	—
10	9014-309	NUT, NYLOCK JAM 1/2-20	2	35 LB-FT
11	9014-110	NUT, HEX 3/8-24	2	30 LB-FT
12	NA	BOLT, HEX 3/8"-24 X 2.50"	2	—

Note: The part positions listed above will be called out in this installation manual as a visual reference to their respective positions during the installation procedure. Refer to these pages during the installation. Count and compare all parts and fasteners to the list above. If parts are missing, contact QA1 at sales@qa1.net.



52803 67-70 FORD MUSTANG
REAR SWAY BAR KIT

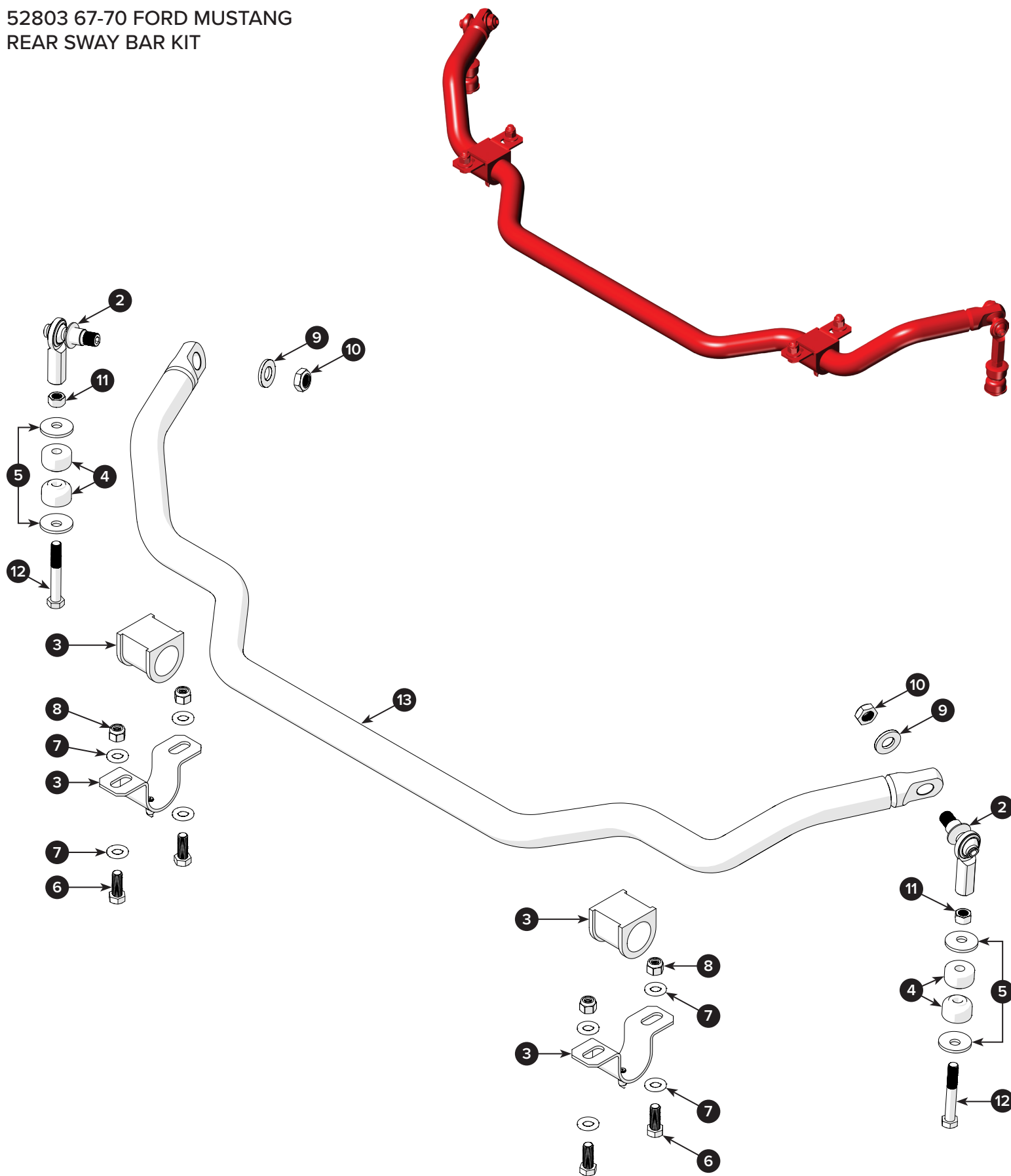

52803 67-70 FORD MUSTANG FRONT SWAY BAR w/INSTALL KIT 7039-482

POSITION	PART #	DESCRIPTION	QTY	TORQUE SPECIFICATION
13	7039-479	SWAY BAR	1	—

67-70 FORD MUSTANG FRONT SWAY BAR INSTALL KIT 7039-482 w/HARDWARE KIT 7039-483

POSITION	PART #	DESCRIPTION	QTY	TORQUE SPECIFICATION
2	PCYFR6TS-101	ROD END (PCY) 2-PC HI-MIS-STUD	2	—
3	9032-171	BUSHING KIT, SWAY BAR FRAME MOUNT 1-1/4"	1	—
4	9032-349	BUSHING, SWAY BAR END LINK	4	—
5	9005-270	WASHER, SWAY BAR BUSHING	4	—

64-70 FORD MUSTANG FRONT SWAY BAR HARDWARE KIT 7039-483

POSITION	PART #	DESCRIPTION	QTY	TORQUE SPECIFICATION
6	9012-229	BOLT, HEX, 3/8-16 X 1.0"	4	30 LB-FT
7	9005-302	WASHER, FLAT 3/8" SAE HARDENED	8	—
8	NA	NUT, NYLOCK 3/8-16	4	—
9	9005-228	WASHER, FLAT 1/2" SAE	2	—
10	9014-309	NUT, NYLOCK JAM 1/2-20	2	35 LB-FT
11	9014-110	NUT, HEX 3/8-24	2	30 LB-FT
12	NA	BOLT, HEX 3/8"-24 X 2.50"	2	—

Note: The part positions listed above will be called out in this installation manual as a visual reference to their respective positions during the installation procedure. Refer to these pages during the installation. Count and compare all parts and fasteners to the list above. If parts are missing, contact QA1 at sales@qa1.net.



Installer's Note: This sway bar only works with the QA1 lower control arm.

These instructions begin on the front driver's side of the vehicle and assumes that the QA1 lower control arm is installed.

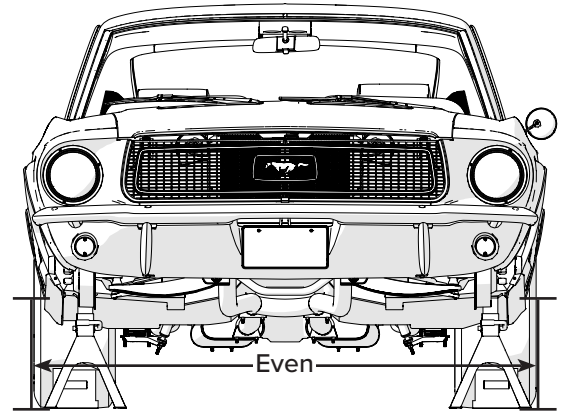

1 If you had just installed the QA1 lower control arm and will now add the sway bar, the wheel has already been removed. Proceed to step 2.

Otherwise, remove the lug nuts and wheels from both the left and right sides of the front of the vehicle for new a sway bar installation.

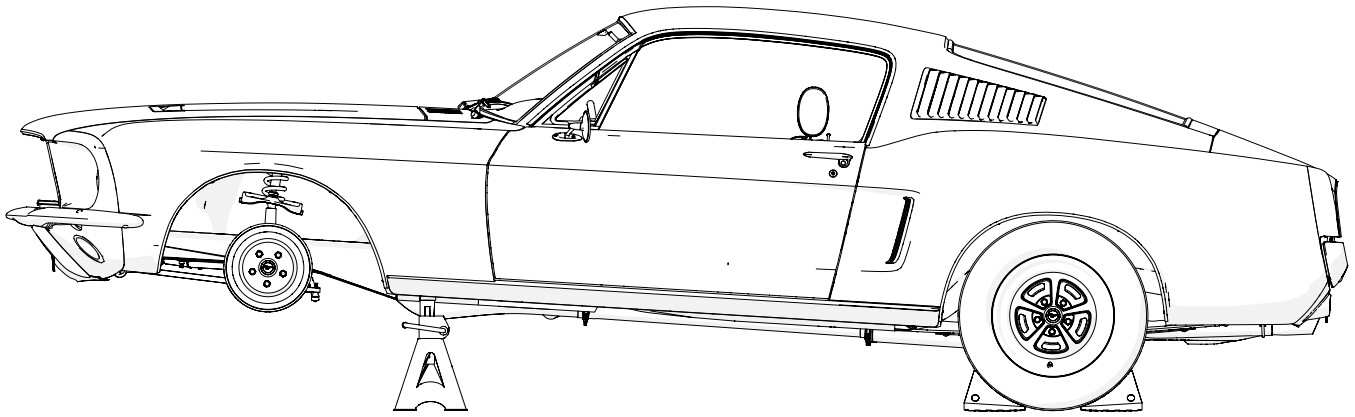

2 First, remove the factory sway bar, if it has not already been removed.

Then, apply grease to the sway bar bushings (3) and press them onto the sway bar (1 or 13).

Make sure the round sides of the bushings face downward.

Note: For easy installation, the sway bar bushings are split on one side.

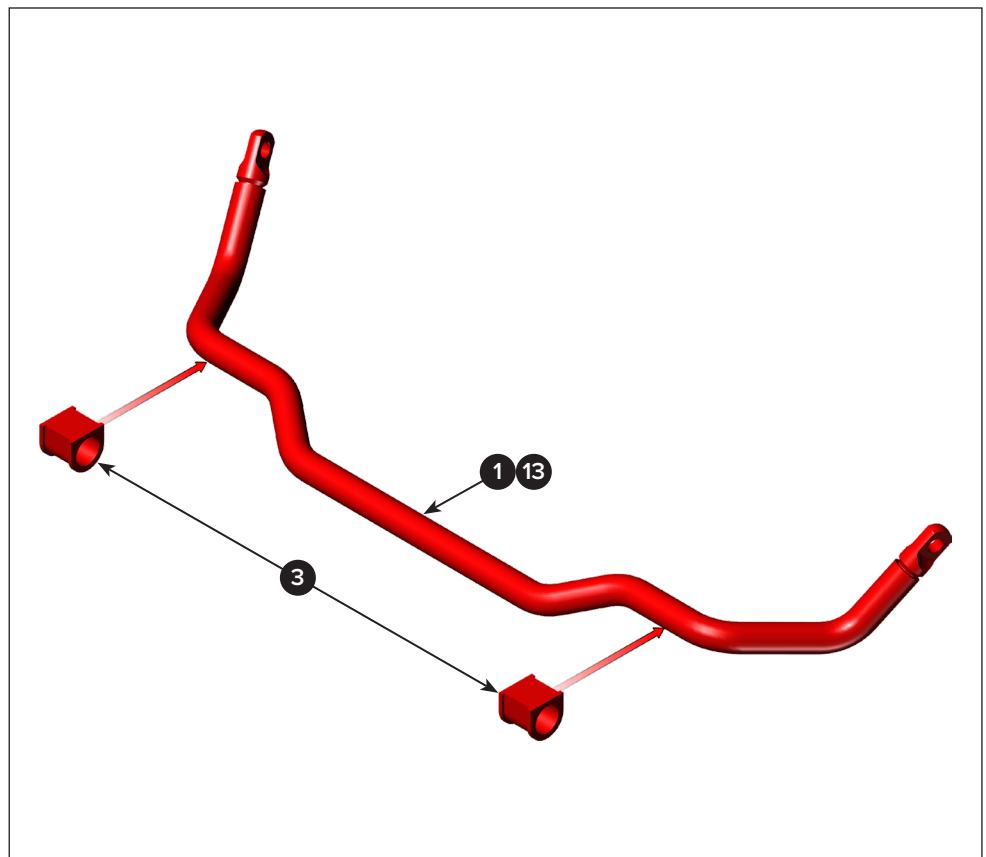

- 3** First, put the sway bar rod ends (2) on the sway bar ends.

Fasten the rod ends to the sway bar with one flat washer (9) and a Nylock jam nut (10).

Use a 1/4" hex key in the stud end to keep it in position, then torque the jam nut to 35 lb-ft.

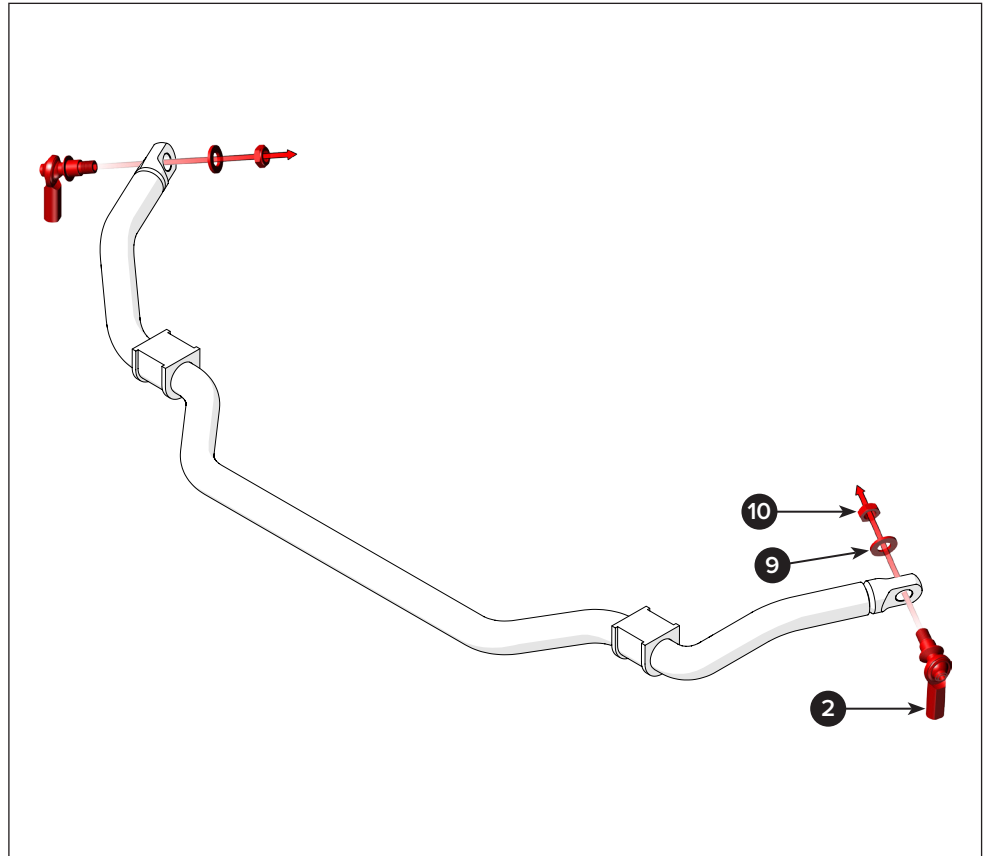

Installer's Note: For visual clarity, the frame and body is not shown.

- 4** Install the sway bar with the arms above the lower control arms, then raise the bushings to the frame mount.

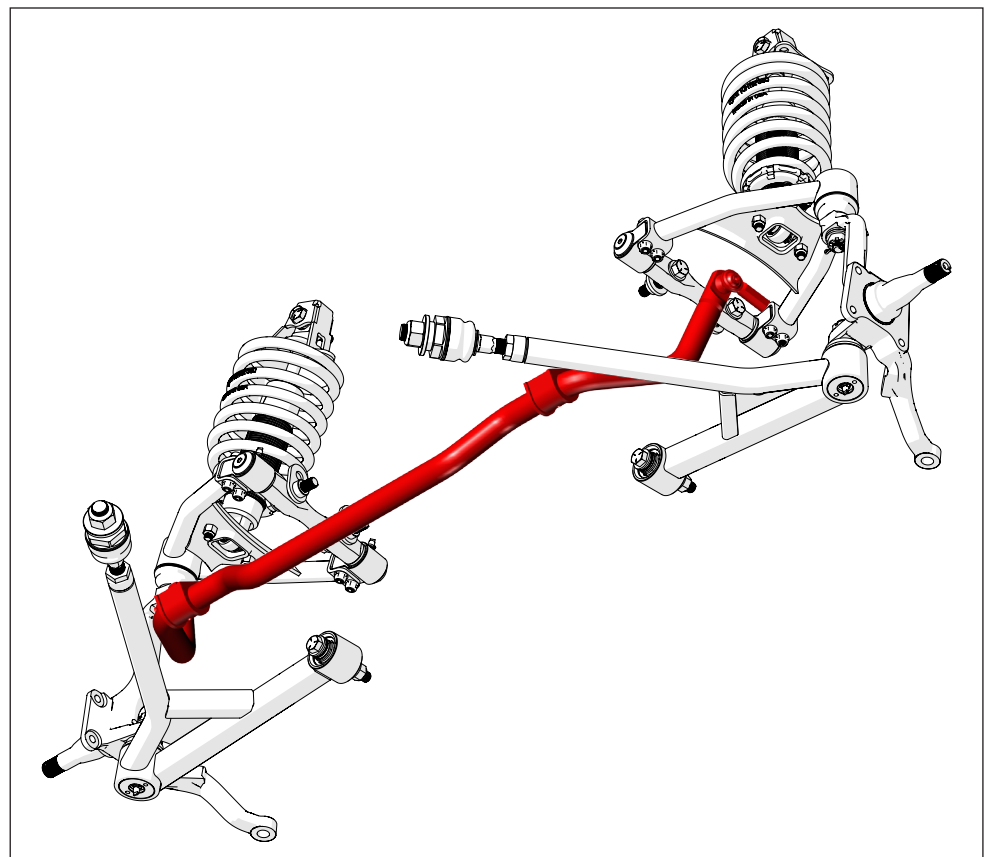

5

Put the sway bar brackets (3) on the bushings, and attach the sway bar with four 3/8" x 1" bolts (6), eight 3/8" flat washers (7), and four 3/8" Nylock nuts (8).

Leave the fasteners loose during installation to allow for adjustment of the sway bar mounts. They will be torqued during step 9.

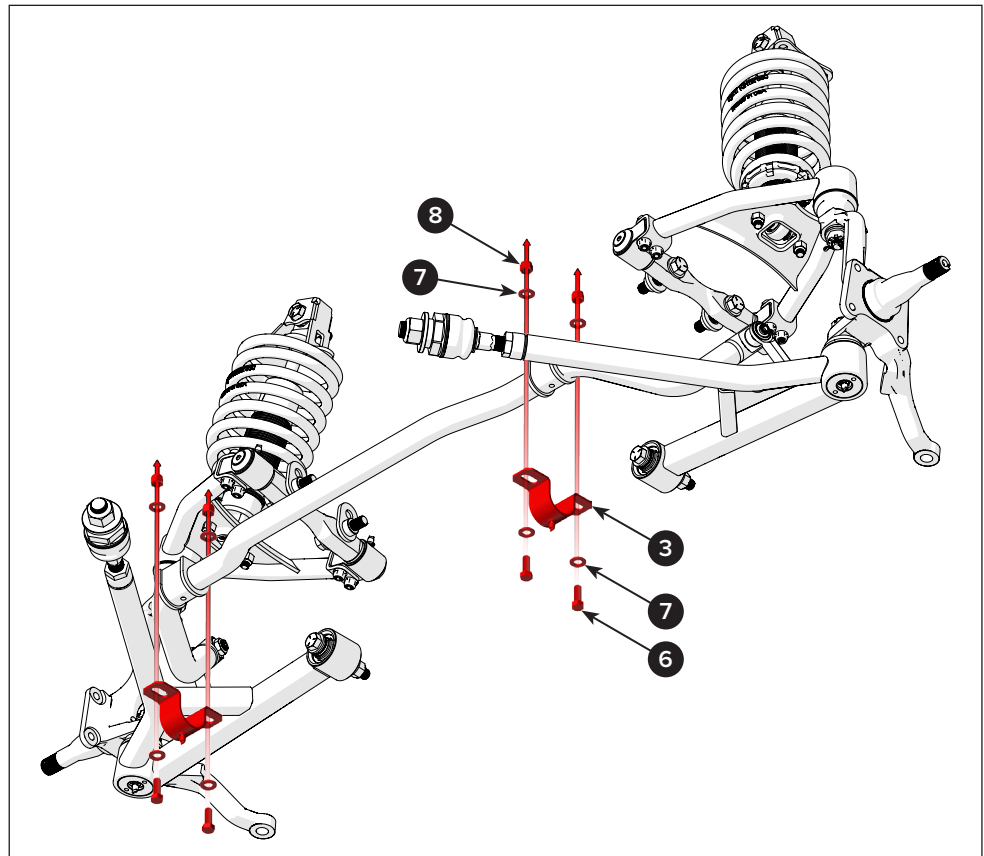

6

First, put one sway bar washer (5) onto the sway bar bolt (12). Then place one sway bar bushing (4) on top of the washer.

Then, put the bolt assembly through the hole in the lower control arm.

After that, put another sway bar bushing (4) and washer (5) on top of the LCA and sway bar bolt.

Turn one hex nut (11) on the bolt threads.

Torque the bolt to 30 lb-ft to compress the bushings.

Now, repeat this assembly procedure for the other sway bar link assembly.

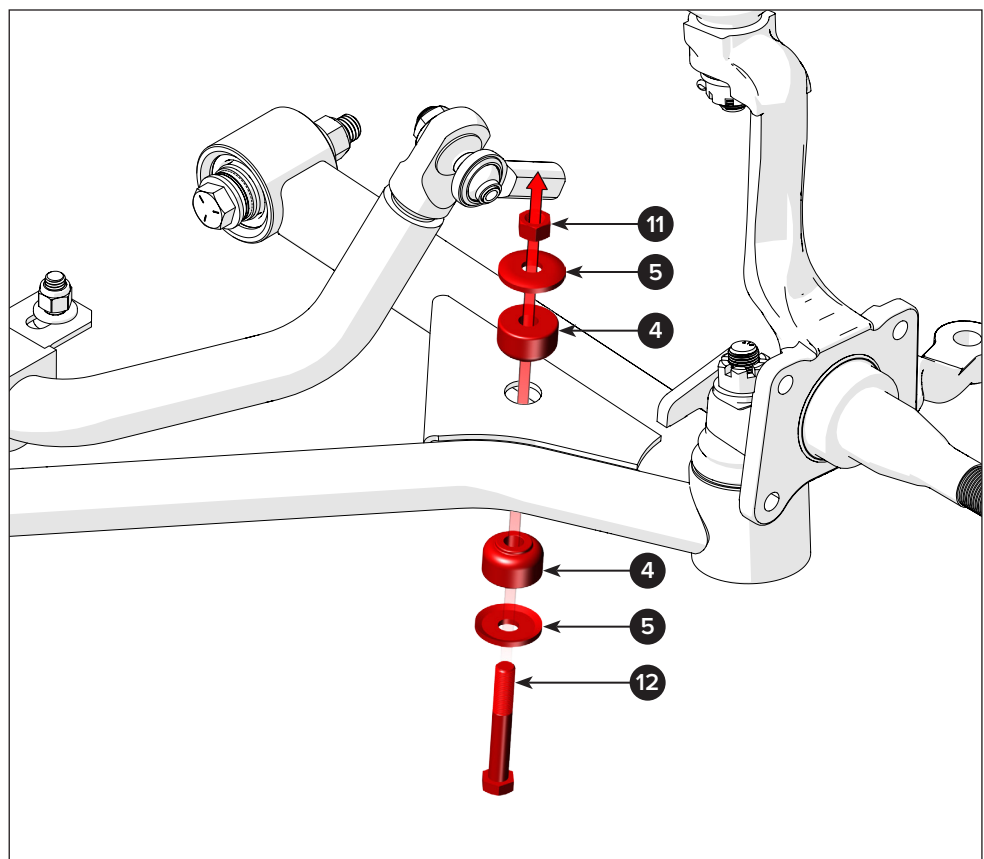

7

Screw the bolt assembly into the bottom of the rod end until it is fully seated with the nut snug against the rod end.

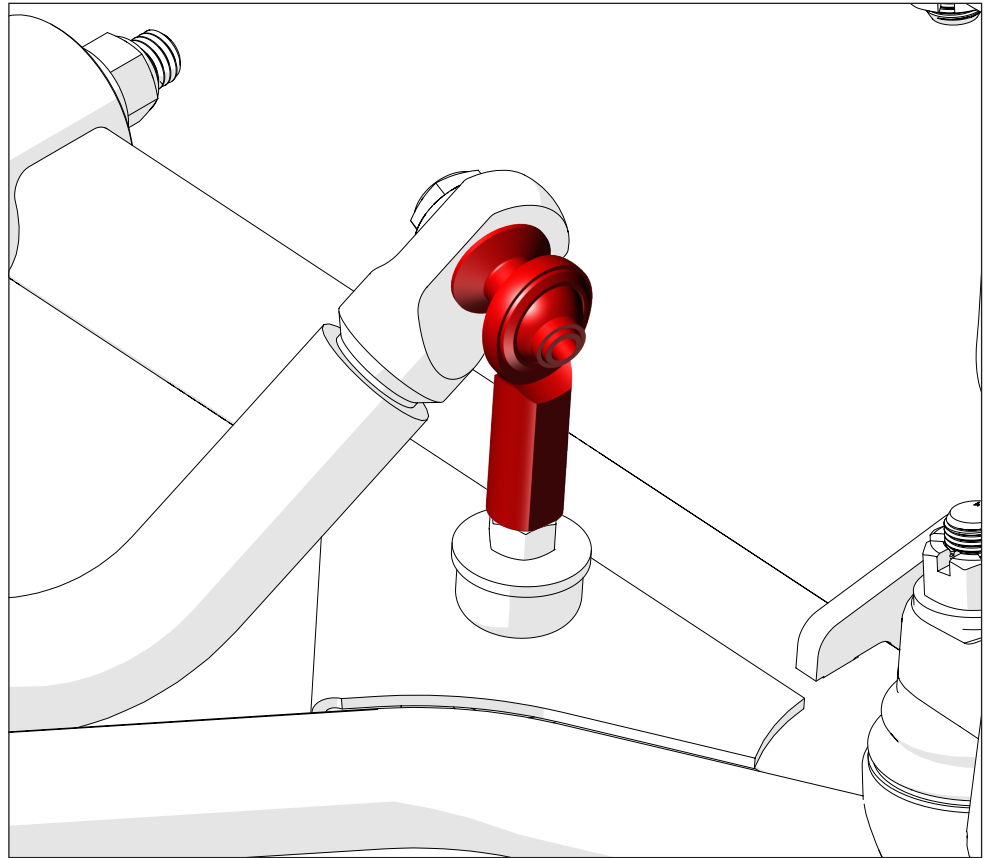

8

Now, use a wrench on the flat sides of the rod end to hold it in position and torque the nut to 30 lb-ft against the rod end.

Now, repeat this assembly procedure for the other sway bar link assembly.

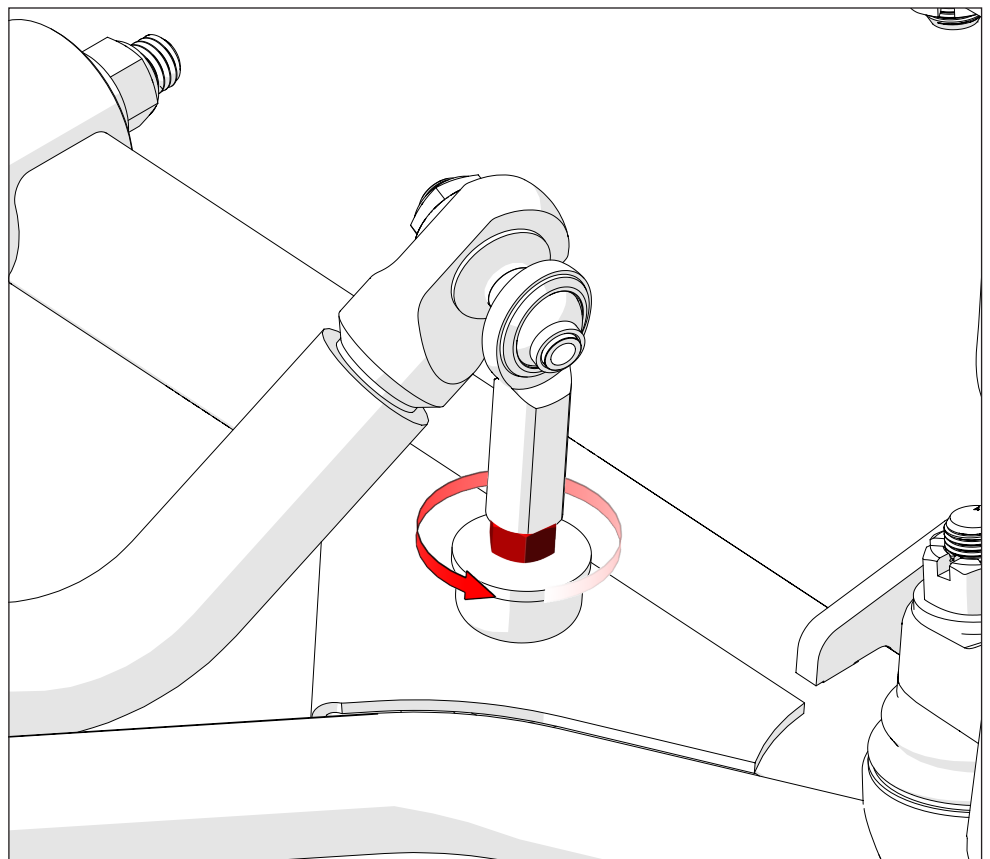

9

Torque the sway bar mounting bolts to 30 lb-ft.

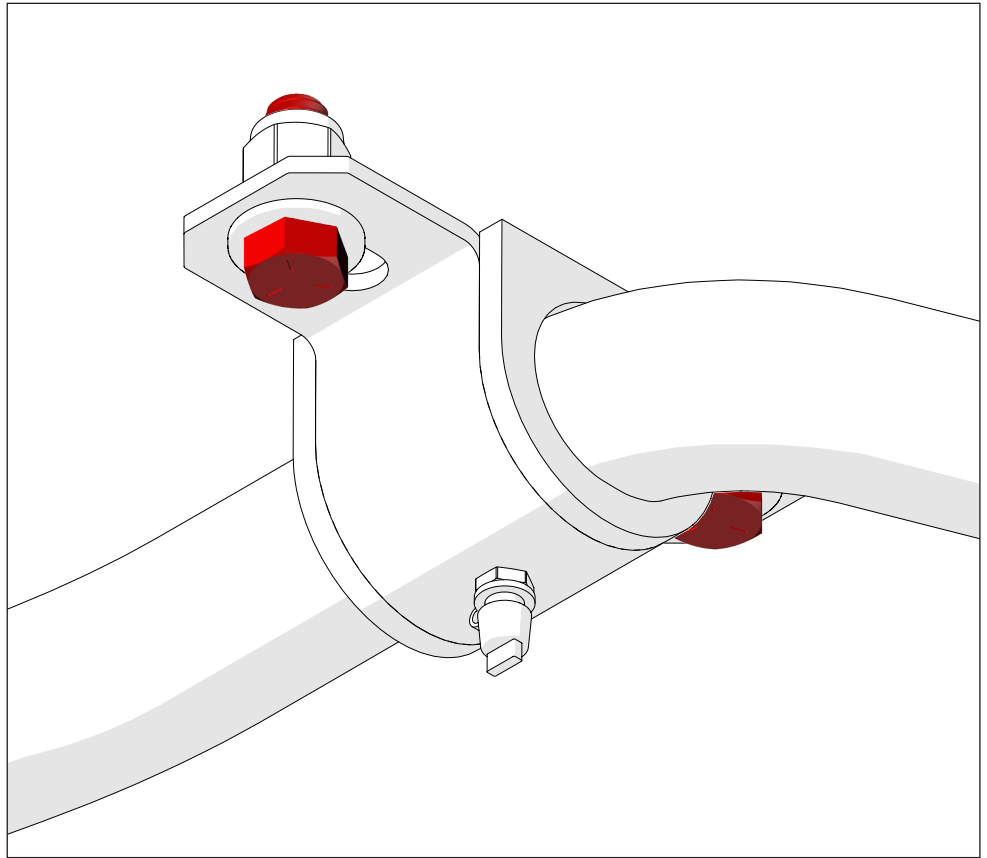

10

Finally, grease the Zerk fittings on the bottom of the sway bar mounting brackets.

Put the wheels back onto the car and torque the wheel nuts to specification.

With the installation complete and the vehicle is on level ground with its tires at ride height, the end links can be adjusted if necessary.

Note: Verify the adjustment to make sure that there is no side-to-side load on the suspension caused by the sway bar.

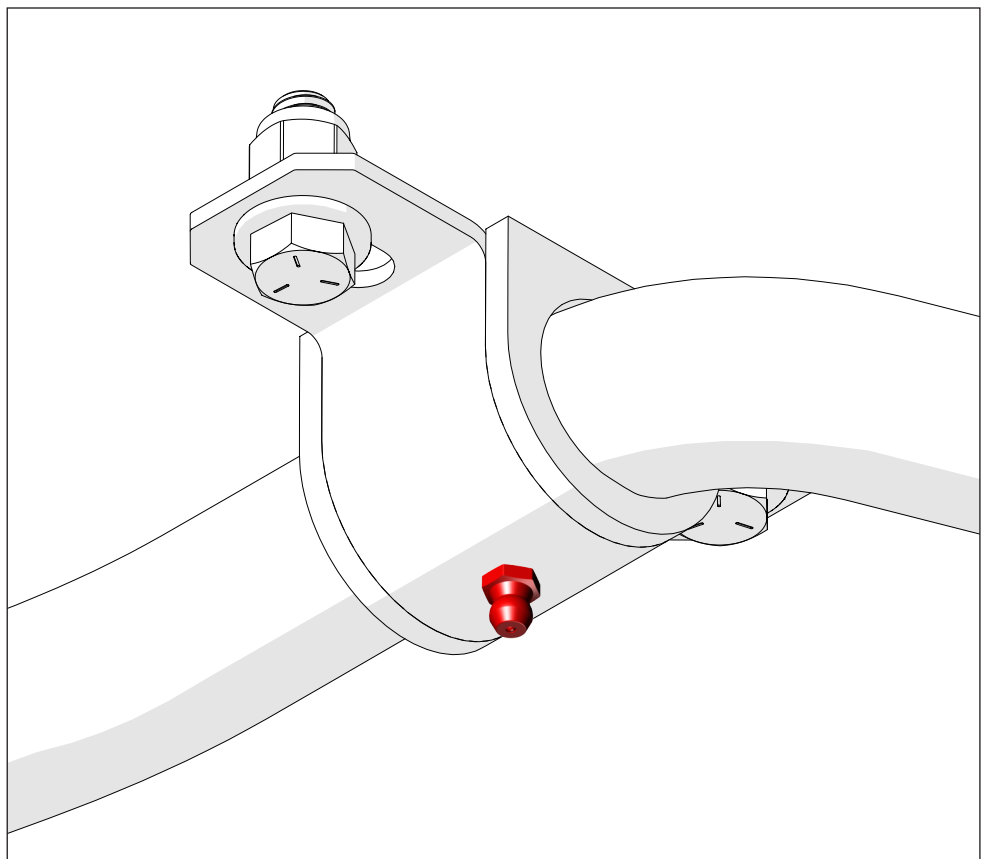

DISCLAIMER / WARRANTY

QA1 warrants the products to be free from defects in material and workmanship for one year from the date of sale to the original purchaser. QA1 makes no other warranty of any kind, expressed or implied.

QA1 shall have no obligation under the preceding warranty where the defect results from improper or abnormal use, your negligence, vehicle accident, inappropriate or incorrect installation or maintenance, nor when the product has been repaired or altered in any way. QA1's liability in the case of defective products subject to the preceding warranty shall be limited to the repair or replacement of the defective products at QA1's option.

The user understands and recognizes that racing parts, specialized street rod equipment, and all parts and services sold by QA1 are exposed to many varied conditions due to the manner in which they are installed and used. It is the user's responsibility to determine the proper use or application of QA1 products.

QA1 shall bear no liability for any loss, damage, or injury, either to a person or to property, resulting from the installation, direct or indirect use of any QA1 products, or inability by the buyer to determine proper use or application of QA1 products. With the exception of the limited liability warranty set forth above, QA1 shall not be liable for any claims, demands, injuries, damages, actions, or causes of action to the buyer arising out of or connected with using any QA1 products.

Motorsports are inherently risky; therefore, no warranty or representation is made as to the product's ability to protect the user from injury or death. The user is fully aware and assumes that risk.



